

## Safety And Regulatory Information

### Safety & Regulatory Information

The following sections contain notices for various countries:

#### Caution

This product is intended for use with FCC/CE certified computer equipment. Please check the equipment operating/installation manual and/or with the equipment manufacturer to verify/confirm if your equipment is suitable prior to the installation or use of the product.

#### Notice for USA

FCC Part 15: This equipment has been tested and found to comply with the limits for a Class B digital device, pursuant to Part 15 of the FCC Rules. These limits are designed to provide reasonable protection against harmful interference in a residential installation. This equipment generates, uses and can radiate radio frequency energy and, if not installed and used in accordance with the instructions, may cause harmful interference to radio communications. However, there is no guarantee that interference will not occur in a particular installation. If this equipment does cause harmful interference to radio or television reception, which can be determined by turning the equipment off and on, the user is encouraged to try to correct the interference by one or more of the following measures:

- Reorient or relocate the receiving antenna.
- Increase the separation between the equipment and receiver.
- Connect the equipment into an outlet on a circuit different from that to which the receiver is connected.
- Consult the dealer or an experienced radio/TV technician for help.

This device complies with part 15 of the FCC Rules. Operation is subject to the following two conditions:

1. This device may not cause harmful interference, and
2. This device must accept any interference received, including interference that may cause undesired operation.

#### Caution

To comply with the limits of the Class B digital device, pursuant to Part 15 of the FCC Rules, this device must be installed with computer equipment certified to comply with Class B limits. All cables used to connect to the computer and peripherals must be shielded and grounded. Operation with non-certified computers or non-shielded cables may result in interference to radio or television reception.

#### Modification

Any changes or modifications not expressly approved by the grantee of this device could void the user's authority to operate the device.

#### State of California Proposition 65:

WARNING: Handling the cord(s) on this product may expose you to lead, a chemical known to the State of California to cause cancer and birth defects or other reproductive harm. Wash your hands after handling.

#### Notice for Canada

This Class B digital apparatus complies with Canadian ICES-003.  
Cet appareil numérique de la classe B est conforme à la norme NMB-003 du Canada.

#### Canadian Class B Statement

This digital device does not exceed the Class B limits for radio noise emissions from digital apparatus as set out in the interference-causing equipment standard entitled "Digital Apparatus," ICES-003 of the Department of Communications.

Cet appareil numérique respecte les limites de bruits radioélectriques applicables aux appareils numériques de Classe B prescrites dans la norme sur le matériel brouilleur: "Appareils Numériques," NMB-003 édictée par le ministre des Communications.

#### MODIFICATION:

Any changes or modifications not expressly approved by the grantee of this device could void the user's authority to operate the device.

Toute modification non approuvée explicitement par le fournisseur de licence de l'appareil peut entraîner l'annulation du droit de l'utilisateur à utiliser l'appareil.

#### For US only:

##### Power rating conforming to FTC Amplifier Rule, 16 CFR Part 432:

Speakers: 11 Watts RMS per speaker  
(measured @ 6 ohms @ 10% THD @ 50Hz - 20kHz, two channels driven)



**WARNING:** To prevent fire or shock hazard, do not expose this appliance to rain or moisture.

#### June

© 2007. Creative Technology Ltd. All rights reserved. The Creative logo and GigaWorks are either registered trademarks or trademarks of Creative Technology Ltd. in the United States and other countries. All other logos, brand or product names are trademarks or registered trademarks of their respective holders and are hereby recognised as such. All specifications are subject to change without notice. Use of this product is subject to a limited warranty. Actual contents may differ slightly from those pictured.

P/N 03MF158500000 Rev. A

# CREATIVE



# CREATIVE

- EN** Quick Start Guide
- FR** Démarrage Rapide
- ES** Guía Rápida
- BP** Introdução rápida
- TR** Kullanım
- CT** 快速開始指南
- JP** クイックスタートガイド
- CS** 快速开始指南

# GIGAWORKS® T40

**EN** English

#### Specifications

##### Creative GigaWorks T40

Power output  
Satellite speaker:  
**14 watts RMS per channel**  
Signal-to-Noise Ratio (SNR):  
**80dB**

Frequency Response:  
**50Hz - 20kHz**

#### For 20V AC input

This product operates from the supplied 20V AC 2.8A power adapter.

#### For 27V DC input

This product operates from the supplied 27V DC 1.7A universal power adapter.

**TR** Türkçe

#### Özellikler

##### Creative GigaWorks T40

Ses çıkışı  
Satellite hoparlör:  
**Kanal başına 14 W RMS**  
İşaret-Gürültü Gücü Oranı:  
**80 dB**

Frekans Yanıtı:  
**50 Hz ~ 20 kHz**

#### 20V AC giriş için

Bu ürün, birlikte gönderilen 20V AC 2.8A güç adaptöründen gelen güçle çalışır.

#### 27V DC giriş için

Bu ürün, birlikte gönderilen 27V DC 1.7A evrensel güç adaptöründen gelen güçle çalışır.

**FR** Français

#### Spécifications

##### Creative GigaWorks T40

Sortie de l'alimentation  
Haut-parleur satellite:  
**14 watts RMS par canal**  
Rapport signal/bruit:  
**80dB**

Réponse en fréquence:  
**50Hz - 20kHz**

#### Pour l'entrée en courant alternatif de 20 V

Ce produit fonctionne avec l'adaptateur d'alimentation fourni de 20 V ca / 2,8 A.

#### Pour l'entrée en courant continu de 27 V

Ce produit fonctionne avec l'adaptateur d'alimentation universel fourni de 27 V cc / 1,7 A.

**CT** 繁體中文

#### 規格

##### Creative GigaWorks T40

功率輸出  
衛星喇叭:  
每聲道 **14 瓦輸出功率**  
訊噪比:  
**80dB**

頻率響應:  
**50Hz ~ 20kHz**

#### 針對 20V AC 輸入

本產品由 20V AC 2.8A 變壓器供電。

#### 針對 27V DC 輸入

本產品由 27V DC 1.7A 通用型變壓器供電。

**ES** Español

#### Especificaciones

##### Creative GigaWorks T40

Salida de alimentación  
Altavoz auxiliar:  
**14 vatios de carga eficaz por canal**  
Relación de señal a ruido:  
**80dB**

Respuesta de frecuencias:  
**50Hz a 20kHz**

#### Para la entrada de ca de 20 V

Este producto funciona con el adaptador de alimentación de ca de 20 V y 2,8 A suministrado.

#### Para la entrada de cc de 27 V

Este producto funciona con el adaptador de alimentación de cc universal de 27 V y 1,7 A suministrado.

**JP** 日本語

#### 仕様

##### Creative GigaWorks T40

出力  
サテライトスピーカー:  
**14W RMS/チャンネル**  
SNR(信噪比):  
**80dB**

周波数特性:  
**50Hz ~ 20kHz**

#### 20V AC入力

この製品は付属の20V AC電源アダプター(2.8A)で駆動します。

#### 27V DC入力

この製品は付属の27V DCユニバーサルアダプター(1.7A)で駆動します。

本製品には販売されている地域に合わせて、ACアダプターまたはDCアダプターのどちらかを付属しています。

**BP** Português do Brasil

#### Especificações

##### Creative GigaWorks T40

Saída de alimentação  
Alto-falante:  
**RMS de 14 watts por canal**  
Relação sinal/ruído:  
**80dB**

Resposta de frequência:  
**50Hz a 20kHz**

#### Para entrada de 20V AC

Este produto funciona com o adaptador de alimentação 20V AC de 2.8A.

#### Para entrada de 27V DC

Este produto funciona com o adaptador universal de alimentação 27V DC de 1.7A.

**CS** 简体中文

#### 规格

##### Creative GigaWorks T40

功率输出  
卫星音箱:  
额定功率 **14 瓦(每声道)**  
信噪比:  
**80dB**

频率响应:  
**50Hz ~ 20kHz**

#### 针对 20V AC 输入

本产品由 20V AC 2.8A 变压器供电。

#### 针对 27V DC 输入

本产品由 27V DC 1.7A 通用型变压器供电。

本品会视所售区域的不同，附带相应规格的 AC 或 DC 电源变压器。

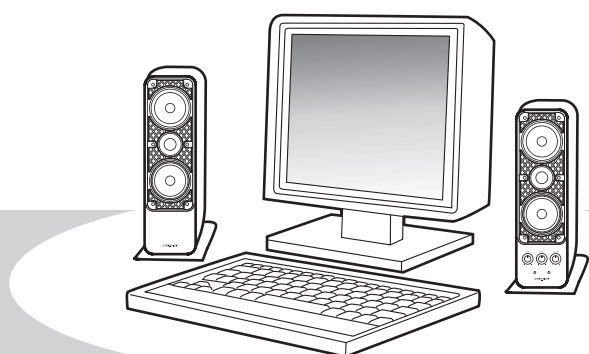

GIGAWORKS T40

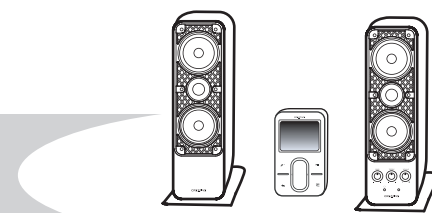

GIGAWORKS T40

- Connectivity Diagram
- Schéma de connexion
- Diagramm zur conectividad
- Diagramm zur conectividade
- Balant diyagram
- 連接示意圖
- 接続図
- 连接示意图

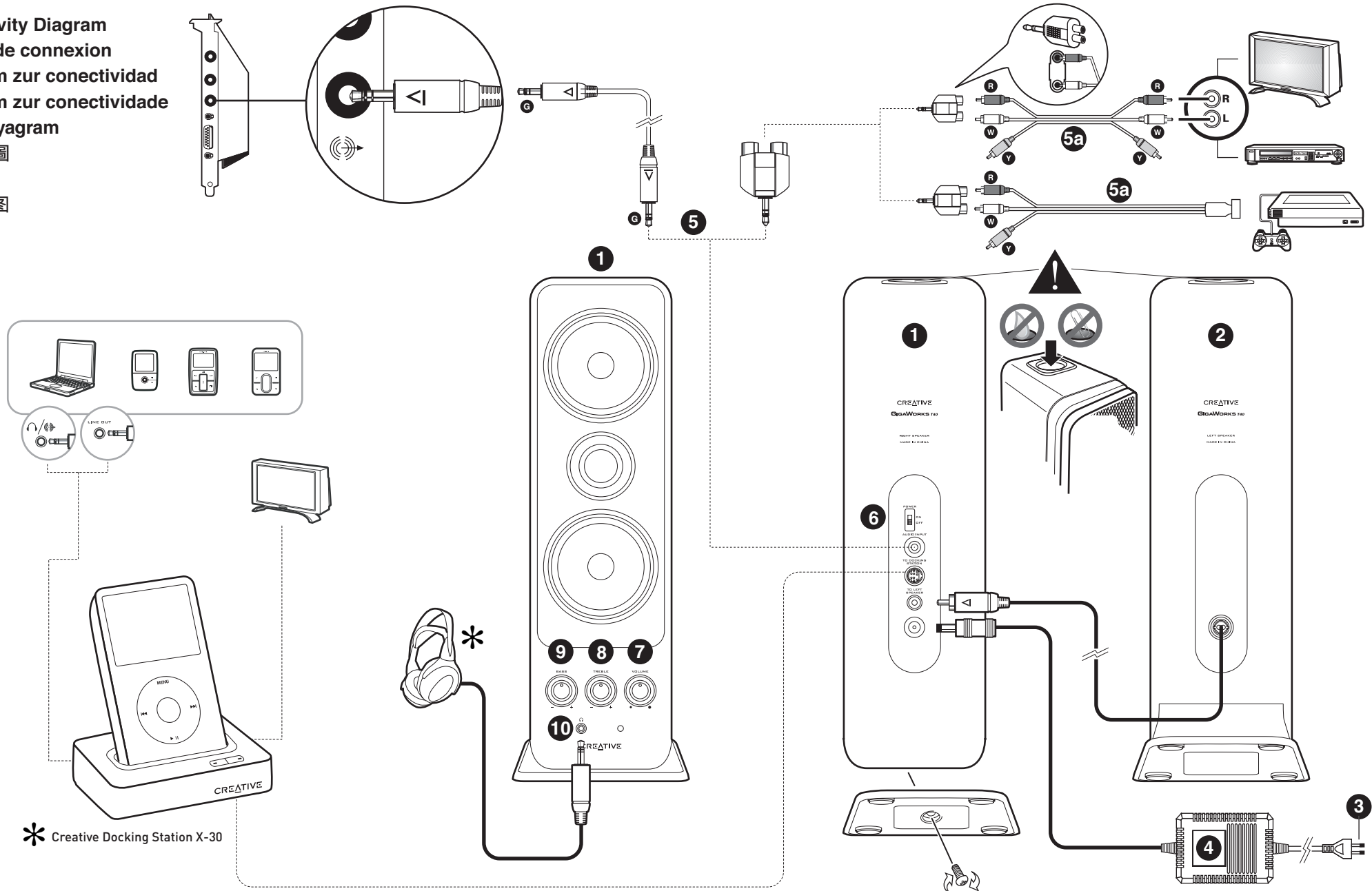

	EN	FR	ES	BP	TU	CT	JP	CS
R	Red	Rouge	Rojo	Vermelho	Kırmızı	紅色	赤	红色
W	White	Blanc	Blanco	Branco	Beyaz	白色	白	白色
Y	Yellow	Jaune	Amarillo	Amarelo	Sarı	黃色	黄色	黄色
G	Lime	Vert clair	Verde	Verde-limão	Limon yeşili	檸檬綠色	綠色	灰綠色

\* • Optional (sold separately) • Facultatif (vendu séparément) • Opcional (se vende por separado) • Opcional (vendido separadamente) • İsteğe bağlı (ayrı olarak sayılır) • 選購配件 (另行購買) • オプション (別売) • 选购件 (另行购买)

	EN English	FR Français	ES Español	BP Português do Brasil	TR Türkçe	CT 繁體中文	JP 日本語	CS 简体中文
1	<b>Right Speaker</b>	<b>Haut-parleur droit</b>	<b>Altavoz derecho</b>	<b>Alto-falante direito</b>	<b>Sağ Hoparlör</b>	<b>右聲道喇叭</b>	<b>サテライトスピーカー(右)</b>	<b>右卫星音箱</b>
2	<b>Left Speaker</b>	<b>Haut-parleur gauche</b>	<b>Altavoz izquierdo</b>	<b>Alto-falante esquerdo</b>	<b>Sol Hoparlör</b>	<b>左聲道喇叭</b>	<b>サテライトスピーカー(左)</b>	<b>左卫星音箱</b>
3	<b>To Wall Outlet</b> (Disconnect when not in use for several days)	<b>Vers la prise mural</b> (Déconnectez le système si vous n'avez pas l'intention de l'utiliser pendant plusieurs jours)	<b>A la toma de corriente</b> (desconéctelo cuando no se vaya a utilizar durante varios días)	<b>Para Tomada Elétrica</b> (Desconectar quando não estiver em uso por vários dias)	<b>Duvar çıkışı</b> (Birkaç gün kullanılmayacak ise bağlantıyı kesin)	<b>至牆壁插座</b> (長時間不用時請拔下電源插頭)	<b>コンセントへ接続</b> (数日間使用しない時はコンセントを抜いて下さい)	<b>至牆壁插座</b> (長時間不用時請拔下電源插頭)
4	<b>Power Supply Adapter</b> (Types of adapter may vary in different countries)	<b>Adaptateur d'alimentation</b> (le modèle peut varier selon le pays)	<b>Adaptador de alimentación</b> (los tipos de adaptadores pueden variar según el país)	<b>Adaptador de Fonte de Alimentação</b> (Os tipos de adaptador podem variar em diferentes países)	<b>Güç kaynağı adaptörü</b> (Adaptör tipinin ülkelere göre farklılık göstermesi mümkündür)	<b>變壓器</b> (不同國家，變壓器類型可能不同)	<b>電源アダプター</b> (付属の電源アダプター以外は使用しないで下さい)	<b>變壓器</b> (不同國家，變壓器類型可能不同)
5	<b>To Analog Audio Source</b>	<b>Vers la source audio analogique</b>	<b>Fuente de sonido análoga</b>	<b>Fonte de áudio analógico</b>	<b>Analog Ses Kaynaklarına</b>	<b>至類比音效源</b>	<b>オーディオ(アナログ)出力へ接続</b>	<b>接至模拟音源出力へ接続</b>
5a	<b>Optional:</b> Audio / Video Cable is normally provided with TV,DVD or game console	<b>Facultatif:</b> Le câble audio / vidéo est généralement fourni avec un poste de télévision, un lecteur DVD ou une console de jeux.	<b>Opcional:</b> El cable de sonido y video normalmente se proporcionan junto con el equipo de TV, DVD o consola de juegos	<b>Opcional:</b> O cabo de Audio / Vídeo é normalmente fornecido com a TV, DVD ou com o console de jogos.	<b>isteğe bağlı:</b> Ses / Görüntü kablosu genellikle TV, DVD ya da oyun konsolu ile birlikte sağlanır	<b>可選:</b> 音源 / 視訊線一般隨 TV, DVD 或遊戲控制台一同提供。	<b>オプション(別売):</b> AVケーブルはテレビやビデオ、DVDプレーヤー、ゲーム機器などに付属しており、この製品には付属していません	<b>可选:</b> 音源 / 視頻線通常隨 TV, DVD 或遊戲平台一同提供。
6	<b>Power ON/OFF Switch</b>	<b>Interrupteur on/off</b>	<b>Interruptor de encendido/apagado</b>	<b>Interruptor Liga/desliga</b>	<b>Güç Açık/Kapalı Düğmesi</b>	<b>電源開關</b>	<b>電源On/O スイッチ</b>	<b>电源开关</b>
7	<b>Volume Control</b>	<b>Commande de volume</b>	<b>Control de volumen</b>	<b>Controle de volume</b>	<b>Ses Yüksekliği Kontrolü</b>	<b>音量控制</b>	<b>ボリュームコントロール</b>	<b>音量控制</b>
8	<b>Treble Level Control</b>	<b>Contrôle de agudos</b>	<b>Control de agudos</b>	<b>Controle de agudos</b>	<b>Tiz Denetimi</b>	<b>高音旋鈕</b>	<b>トレブルレベルコントロール</b>	<b>高音控制</b>
9	<b>Bass Level Control</b>	<b>Bouton de réglage des basses</b>	<b>Control de nivel de graves</b>	<b>Controlo do nível de graves</b>	<b>Düğmesiyle Ses Yüksekliği Denetimi</b>	<b>低音旋鈕</b>	<b>バスレベルコントロール</b>	<b>低音音量控制</b>
10	<b>Headphone Jack</b>	<b>Prise Casque</b>	<b>Conector de auriculares</b>	<b>Connector de fones de ouvido</b>	<b>Kulaklık Jaki</b>	<b>耳機插孔</b>	<b>ヘッドフォンジャック</b>	<b>耳机插孔</b>
!	<b>Object And Liquid Entry</b> Never push any object through the openings, as this can result in a fire, electric shock or damage. Do not spill liquids on the product.	<b>Objets et liquide dans l'appareil</b> N'insérez jamais d'objets dans le produit au travers des ouvertures afin d'éviter tout risque d'incendie, d'électrocution ou d'endommagement. Ne renversez aucun liquide sur le produit.	<b>Introducción de objetos y líquidos</b> Nunca introduzca un objeto de ninguna clase a través de las ranuras del producto, ya que esto puede ocasionar incendios o cortocircuitos. No vierta líquido alguno en el producto.	<b>Inserção De Objetos E Líquidos</b> Jamais coloque objetos pelos orifícios, pois isso pode causar incêndio, choque elétrico ou estragos. Não derrame líquidos no produto.	<b>Nesne Ve Sivi Girişi</b> Asla ürün üzerinde bulunan boşluklardan içeri herhangi bir nesne sokmayın; bu yangın, elektrik çarpması ya da hasara neden olabilir. Ürünün üzerine sıvı dökmeyin.	<b>異物と液體流入</b> 絕對不要任何異物從開口處流入音箱中，否則可能會觸及到危險電壓的部分或使其元件短路。絕對不要任何液體灑落到音箱上	<b>異物および液体の侵入</b> 部品のショートによる火災や感電をおこす危険性がある為、本製品の開口部から異物を入れないようにして下さい。本製品には、いかなる液体もこぼさないようにして下さい。	<b>物体和液体进入</b> 绝对不能把任何物体从开口处放入音箱中，否则可能会触及到危险电压的部分或者使其部件短路。绝对不能将任何液体洒落到音箱上。