

Surface™

Get Around Windows RT

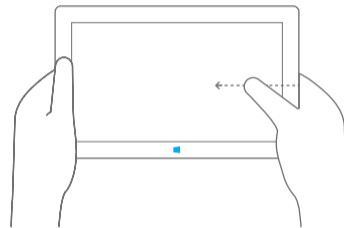

With touch, swipe in from any edge.
If you're using trackpad, move your
pointer into any corner.

Get Around Surface

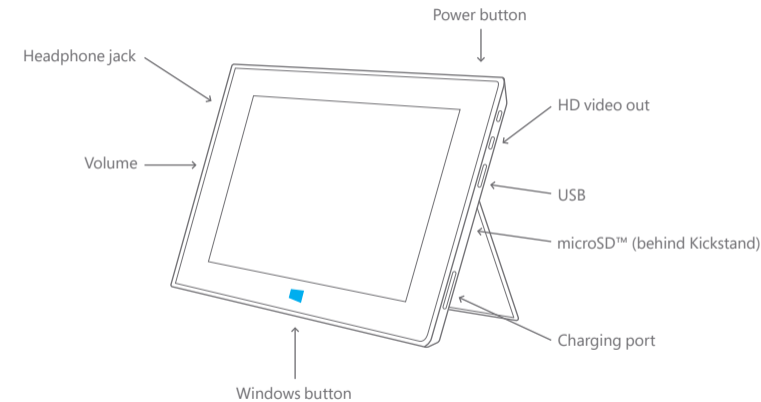

www.microsoft.com/surface



1. Hardware Setup

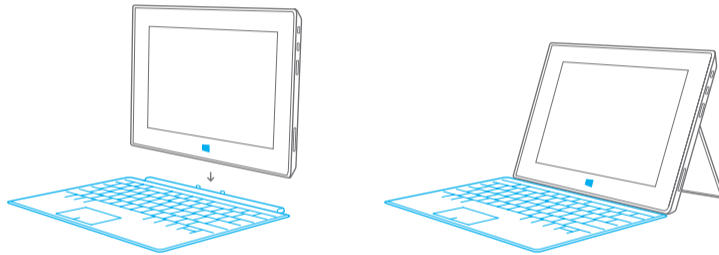

Connect Touch Cover or Type Cover and flip out the Kickstand.

2. Software Setup

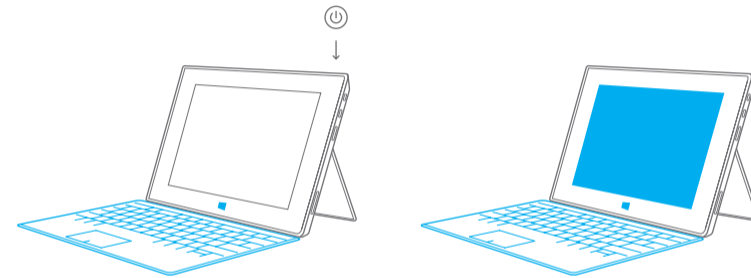

Press Power button and follow the on-screen instructions.